



7650 Round Tank + Injector



Low-Profile Narrow Tank



30" Top Fill Port

All tanks have independent running gear, independent axles, hydraulic suspension, 4-blade 15" impeller, 6" brass hydro/pneumatic valve, 30" top fill port, sump w/drain, 1/4" steel tank, auto-steering w/lock-out, 2-wheel hydr brakes w/spring return, safety chain, 2 1/4" Bull Pull hitch, LED light kit

**TANDEM AXLES, Round Tank**

	Stock No	Weight	List
4300 Gal, 79" diameter, 1 baffle, 5" spindles, 28Lx26 radial tires, 120+ hp	4300	11500#	\$52,662
4900 Gal, 84" diameter, 1 baffle, 5" spindles, 28Lx26 radial tires, 150+ hp	4900	12250#	\$53,151
5500 Gal, 89" diameter, 1 baffle, 5" spindles, 28Lx26 radial tires, 180+ hp	5500	13125#	\$55,424
6000 Gal, 79" diameter, 1 baffle, 6" spindles, 30.5x32 radial tires, 200+ hp	6000	16350#	\$61,912
6800 Gal, 84" diameter, 1 baffle, 6" spindles, 30.5x32 radial tires, 200+ hp	6800	20350#	\$72,329
7650 Gal, 89" diameter, 1 baffle, 6" spindles, 30.5x32 radial tires, 200+ hp	7650	20500#	\$74,776

**TANDEM AXLES, Low-Profile Narrow Tank**

	Stock No	Weight	List
4800 Gal, 2 baffles, 5" spindles, 28Lx26 radial tires, 150+ hp	4800LPN	12500#	\$52,823
5100 Gal, 2 baffles, 5" spindles, 28Lx26 radial tires, 150+ hp	5100LPN	13000#	\$54,414
5750 Gal, 2 baffles, 5" spindles, 28Lx26 radial tires, 150+ hp	5750LPN	13500#	\$57,520
6350 Gal, 4 baffles, 6" spindles, 30.5x32 radial tires, 200+ hp	6350LPN	20000#	\$63,554
6800 Gal, 4 baffles, 6" spindles, 30.5x32 radial tires, 200+ hp	6800LPN	20350#	\$74,260
7650 Gal, 4 baffles, 6" spindles, 30.5x32 radial tires, 200+ hp	7650LPN	20500#	\$76,937

**TRIPLE TRIDEM AXLES, Round Tank**

	Stock No	Weight	List
7500 Gal, 79" diameter, 2 baffles, 5" spindles, 30.5x32 radial tires, 200+ hp	7500	23000#	\$82,694
8500 Gal, 84" diameter, 2 baffles, 5" spindles, 30.5x32 radial tires, 240+ hp	8500	24000#	\$87,374
9500 Gal, 89" diameter, 2 baffles, 5" spindles, 30.5x32 radial tires, 280+ hp	9500	24500#	\$93,213

**TRIPLE TRIDEM AXLES, Low-Profile Narrow Tank**

	Stock No	Weight	List
7300 Gal, 4 baffles, 5" spindles, 30.5x32 radial tires, 200+ hp	7300LPN	23500#	\$83,956
8300 Gal, 4 baffles, 5" spindles, 30.5x32 radial tires, 240+ hp	8300LPN	24000#	\$88,830
9300 Gal, 4 baffles, 5" spindles, 30.5x32 radial tires, 280+ hp	9300LPN	24500#	\$94,612

**POPULAR OPTIONS**

	Stock No	Weight	List
High-volume dairy impeller, 17.5", 1000 PTO only			\$535
Dairy Agitator, 6" full flow, w/valve			Call
Rock Trap, 6" sump drain w/brass valve			\$315
Hydraulic Drive, rather than PTO drive, ADD			\$1,118
Injectors, truck-mount tanks, spindle & tire upgrades, PTO upgrades, other options			Call

**FREIGHT:** FOB Mt Lake MN; \$2.50 to \$3.50 per mile, depending on size (wide load). Tanks arrive fully assembled.  
**FACTORY WARRANTY:** 1 Year on parts (10 Years on tank shell collapse), FOB factory; no labor; w/limitations.  
 All orders are also subject to the dealer Sales & Security Agreement, our latest Discounts and Terms, and credit approval.



6500 Gal Tandem



"Eliminator" Boom Tank + Injectors



"Eliminator" Boom Loading from Semi

**TANDEM AXLES, Round Tank** **Stock No** **Weight** **List**

4300 Gal, 79" diameter, 1 baffle, MEC 6500 pump, 5" spindles, 28Lx26 radial tires, 120+ hp	4300	11500#	\$52,773
4900 Gal, 84" diameter, 1 baffle, MEC 6500 pump, 5" spindles, 28Lx26 radial tires, 150+ hp	4900	12250#	\$54,111
5500 Gal, 89" diameter, 1 baffle, MEC 8000 pump, 5" spindles, 28Lx26 radial tires, 180+ hp	5500	13125#	\$56,308
6000 Gal, 79" diameter, 1 baffle, MEC 8000 pump, 6" spindles, 30.5x32 radial tires, 200+ hp	6000	16350#	\$72,354
6800 Gal, 84" diameter, 1 baffle, MEC 8000 pump, 6" spindles, 30.5x32 radial tires, 200+ hp	6800	20350#	\$73,198
7650 Gal, 89" diameter, 1 baffle, MEC 8000 pump, 6" spindles, 30.5x32 radial tires, 200+ hp	7650	20500#	\$82,994

**TANDEM AXLES, Narrow Tank** **Stock No** **Weight** **List**

6500 Gal, 84" diameter, 1 baffle, MEC 8000 pump, 6" spindles, 30.5x32 radial tires, 200+ hp	6500N	20350#	\$75,569
7350 Gal, 89" diameter, 1 baffle, MEC 8000 pump, 6" spindles, 30.5x32 radial tires, 200+ hp	7350N	20500#	\$85,093

**TRIPLE TRIDEM AXLES, Round Tank** **Stock No** **Weight** **List**

8500 Gal, 84" diameter, 2 baffles, Jurop R260 pump, 5" spindles, 30.5x32 radial tires, 240+ hp	8500	24000#	\$98,146
9500 Gal, 89" diameter, 2 baffles, Jurop R260 pump, 5" spindles, 30.5x32 radial tires, 280+ hp	9500	24500#	\$100,671

**TRIPLE TRIDEM AXLES, Narrow Tank** **Stock No** **Weight** **List**

8000 Gal, 84" diameter, 2 baffles, Jurop R260 pump, 5" spindles, 30.5x32 radial tires, 240+ hp	8000N	24000#	\$100,193
9000 Gal, 89" diameter, 2 baffles, Jurop R260 pump, 5" spindles, 30.5x32 radial tires, 280+ hp	9000N	24200#	\$101,982

"Eliminator" Boom Tank, hydraulic controlled boom loader Call

**Eliminator advantages** - stress-reducing steering axles (not rigid), repairable bolt-on liquid trap tank, independent axles, stronger 4-piston brake calipers (not 2-piston); ballast cooled (not air cooled) Jurop vacuum pump runs cooler when dirty; hydraulic discharge impeller for application rate control & to avoid overworking the vacuum pump; inset tires for narrow road width.

**OPTIONS (Call for other options & truck mount versions)** **Stock No** **Weight** **List**

Extra 6" vacuum intake port, with manual valve			\$621
Vacuum hose, 6" x 10' extension, with couplers			\$523
Delete brakes, 5" and 6" spindle models, DEDUCT			\$2,103
1 3/4" 1000 rpm PTO, rather than standard, ADD			\$243
Hydraulic drive, exchange for PTO drive, for <b>20 gpm maximum flow</b> , ADD			\$1,118
MEC 8000 vacuum pump, rather than 6500, ADD			\$636
Jurop R260 pump, for vane cooler for constant running with a nurse tank, rather than 8000, ADD			\$3,311

**FREIGHT:** FOB Mt Lake MN; \$2.50 to \$3.50 per mile, depending on size (oversize load). Tanks arrive fully assembled.  
**FACTORY WARRANTY:** 1 Year on parts (10 Years on tank shell collapse), FOB factory; no labor; w/limitations.  
 All orders are also subject to the dealer Sales & Security Agreement, our latest Discounts and Terms, and credit approval.



Buckhead Pump



Dairy V-8 PTO Pump



V-6 Pump Agitation



Super 150 Impeller

**PORTABLE SUCTION PUMPS** **List**

Buckhead <b>high volume 6"</b> pump, 540 or 1000 PTO	\$9,187
Buckhead <b>high volume 8"</b> pump, 540 or 1000 PTO	\$9,948
CriMan <b>high pressure 6"</b> pump, 540 or 1000 PTO	\$12,476
Pump with 2 6" valves, ADD	\$66
Pump with 1 6" & 1 8" valve, ADD	\$529

**VERTICAL PUMPS, ELECTRIC** **List**

<b>LE 80 Pump (3 1/4")</b> , ADD 5hp C-face motor	
6-Foot LE 80 Pump (up to 78" depth)	\$4,678
8-Foot LE 80 Pump (up to 98" depth)	\$4,809
10-Foot LE 80 Pump (up to 118" depth)	\$4,946
13-Foot LE 80 Pump (up to 157" depth)	\$4,946
Wall mount bracket, LE 80	\$174
Motor, 5 hp 1 phase, coupler, installed	\$1,165
Motor, 5 hp 3 phase, coupler, installed	\$1,230
Hydraulic motor, installed	\$1,310
<b>LE 120 Pump (5")</b> , w/agitator, ADD 10-15hp motor	
6-Foot LE 120 Pump (up to 78" depth)	\$7,390
8-Foot LE 120 Pump (up to 98" depth)	\$7,731
10-Foot LE 120 Pump (up to 118" depth)	\$8,011
13-Foot LE 120 Pump (up to 157" depth)	\$8,358
Wall mount bracket, LE 120	\$259
Floor mount bracket, LE 120	\$259
High-output impeller, for 20-40 hp motor, ADD	\$581
Motor, 10 hp 1 phase, coupler, installed	\$2,104
Motor, 15 hp 1 phase, coupler, installed	\$5,698
Motor, 10 hp 3 phase, coupler, installed	\$1,828
Motor, 15 hp 3 phase, coupler, installed	\$2,136
Motor, 20 hp 3 phase, coupler, installed	\$2,491
Motor, 25 hp 3 phase, coupler, installed	\$3,105
Motor, 30 hp 3 phase, coupler, installed	Call
Motor, 40 hp 3 phase, coupler, installed	Call

**VERTICAL PUMPS, PTO** **List**

DAIRY Pump, welded impeller, straw knives, triple seals, oil bath drive, 4-way 18" stainless agitator, 2-point trailer, hydr controls	
V-6, <b>6" Pump</b> , 20" impeller, 6',8',10' or 12' (1700#)	\$10,314
P-6, <b>6" Pump, full-time prop</b> , 6',8',10' or 12'	\$13,319
V-8, <b>8" Pump</b> , 22" impeller, 6',8',10' or 12'	\$13,512
1000 PTO drive, ADD	N/C
Finger-Tip hydr control valves	Call
Gearbox oil cooler (standard on V-8), ADD	\$1,174
10" or 24" agitation nozzle, rather than 18"	N/C
SUPER 150 Pump (6"), straw chopper, galvanized tubes, oil bath drive, 4-way agitator, 2-point trailer, hydr winch/tilt, 540 PTO	
6-Foot Super 150 Pump (for pits 54" - 78")	\$10,832
8-Foot Super 150 Pump (for pits 74" - 98")	\$11,104
10-Foot Super 150 Pump (for pits 94" - 118")	\$11,420
13-Foot Super 150 Pump (for pits 133" - 157")	\$13,525
1000 PTO drive, ADD	N/C
Additional top agitation nozzle, ADD	\$960

**OPTIONS, FITTINGS, LOAD STANDS** **List**

Elbows - 3.25" fem-4" male \$50	6" female-6" male \$80		
4" female-4" male \$50	6" female-6" female \$80		
4" female-6" male \$80	6" female-8" male \$140		
5" female-4" male \$60	8" female-8" male \$170		
5" female-6" male \$80			
Couplers - 4" female \$35	6" female \$50	8" female \$80	
4" male \$20	6" male \$40	8" male \$90	
Clamps (use 2-3 per coupler)	4" \$5.00	6" \$7.00	8" \$12.00
Hose, 125psi (per ft)	4" \$5.10	6" \$9.40	8" \$13.50
6"x30' BIPOD load stand, female direct-fit coupler			\$1,962
6"x30' REMOTE load stand, couplers, 12' hose, tires			\$2,832
8"x30' BIPOD load stand, female direct-fit coupler			\$2,040
8"x30' REMOTE load stand, couplers, 12' hose, tires			\$3,305
8"x40' HD REMOTE load stand, couplers, 12' hose, tires			\$3,532

**FREIGHT:** Utah, So. Idaho 6% of list price; Other Areas 9%.  
**FACTORY WARRANTY:** 1 Year on parts (5 yrs on gearbox, 2 yrs on impeller, NO SAND), FOB factory; no labor; w/limitations.  
 All orders are also subject to the dealer Sales & Security Agreement, our latest Discounts and Terms, and credit approval.



Magnum 43' Pump + Veneroni Impeller



V-6 Dairy Impeller



Trailed Prop Agitator

**MAGNUM LAGOON PUMPS**

	Stock No	Weight	List
38' MAGNUM Pump, vertical V-6 Dairy Special impeller with chopper, 19.5" prop agitator, rotating/tilting agitator nozzle, 4" truck driveline, triple seal system, hydr lift, single wheels, 24 tires, control valves, 6" female coupler, 540 or 1000 PTO (140 hp min)	LAG38-V6		\$19,845
48' MAGNUM S-150, as above but with dual wheels, 4 tires	LAG48-V6		\$27,320
58' MAGNUM S-150, as above but with dual wheels, 4 tires	LAG58-V6		\$29,540
Veneroni Super 150 Impeller, rather than V-6 impeller, with 19.5" prop, 540 or 1000 PTO			N/C
Wall climber			\$7,518
Remote control, electric wireless, for load out valve			Call
6"x30' REMOTE load stand, couplers, 12' hose, recapped tires			\$2,832
8"x30' REMOTE load stand, couplers, 12' hose, recapped tires			\$3,305
8"x40' HD REMOTE load stand, couplers, 12' hose, recapped tires			\$3,532

**PROPELLER AGITATORS**

	Stock No	Weight	List
21' 3-point mounted propeller agitator, CHOOSE PTO speed, CHOOSE prop diameter			\$9,499
38' Trailer mounted propeller agitator, 4" driveline, CHOOSE PTO speed, CHOOSE prop diameter			\$15,557
48' Trailer mounted propeller agitator, 4" driveline, CHOOSE PTO speed, CHOOSE prop diameter			\$17,937
58' Trailer mounted propeller agitator, 4" driveline, CHOOSE PTO speed, CHOOSE prop diameter			\$19,239
Power Required, 540 rpm: 19" prop 40 hp; 23.5" prop 75 hp; 28" prop 110 hp			
Power Required, 1000 rpm: 19" prop 90 hp; 23.5" prop 125 hp; 28" prop 160 hp			

FREIGHT: FOB Mountain Lake MN 56159. Call for freight estimate.  
 FACTORY WARRANTY: 2 Years on parts (no sand bedding), FOB factory; no labor; with limitations.  
 All orders are also subject to the dealer Sales & Security Agreement, our latest Discounts and Terms, and credit approval.



1550 Tridem Cart



Independent Axles, Full 14" Travel



Steering Track Option



Hydr 2-Way Spout Control



Joystick

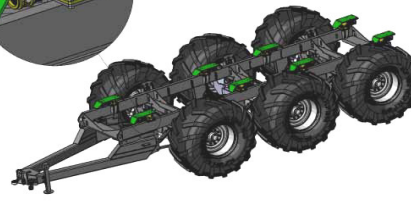
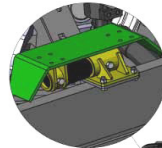

6-8 Weigh Bar Scale System



Grease Banks

**FIELD FLOATER GRAIN CARTS - 24" Auger in 25.5" Tube**

	Stock No	Weight	List
1325 Bushel Tandem Axle, steering, scale, lights, auto oiler, hydr swivel spout, joystick, 30.5x32 tires	FF1325-2	28200#	\$105,250
1325 Bushel Triple Axle, steering, scale, lights, auto oiler, hydr swivel spout, joystick, 30.5x32 tires	FF1325-3	30000#	\$122,150
1325 Bushel Quad Tracks, steering, scale, lights, auto oiler, hydr swivel spout, joystick	FF1325-T		\$151,900
1550 Bushel Tandem Axle, steering, scale, lights, auto oiler, hydr swivel spout, joystick, 30.5xR32 tires	FF1550-2	28700#	\$116,350
1550 Bushel Triple Axle, steering, scale, lights, auto oiler, hydr swivel spout, joystick, 30.5x32 tires	FF1550-3	30500#	\$124,950
1550 Bushel Quad Tracks, steering, scale, lights, auto oiler, hydr swivel spout, joystick	FF1550-T		\$154,700
2000 Bushel Triple Axle, steering, scale, lights, auto oiler, hydr swivel spout, joystick, 30.5xR32 tires	FF2000-3	32500#	\$131,150
2000 Bushel Quad Tracks, steering, scale, lights, auto oiler, hydr swivel spout, joystick	FF2000-T		\$155,755

**OPTIONS**

	Stock No	Weight	List
Extra grain cleanout door for horizontal auger (one is standard, can add two more), EACH			\$526
Roll tarp package, not installed			\$2,717
Hydraulic jack, rather than manual, ADD			\$458
6" Solid spindle/hub assembly, rather than 5", tandem axles			\$3,960
6" Solid spindle/hub assembly, rather than 5", triple axles			\$5,941
Hydraulic brakes on two wheels			\$3,800
Tire options			Call
Delete electronic scale system, DEDUCT			(\$4,500)
Memory stick with cables & software, Weightronics TDS40			\$601
Printer with cable			\$751
1040 Indicator, rather than 640M, ADD			\$568
3060 Touchscreen indicator, Field Foreman software, rather than 640M, ADD			\$4,036
Field Linx software for Windows, for 3060 indicator only, ADD			\$640

**FREIGHT** (overwidth, requires RGN trailer): \$4,500 to \$6,000, depending on location. Call for a quote.  
**FACTORY WARRANTY:** 1 Year on parts, FOB dealer; no labor; w/limitations.  
 All orders are also subject to the dealer Sales & Security Agreement, our latest Discounts and Terms, and credit approval.



Orchard Shredder



Center Drive Shredder



Side Cut Knife Option

**HD ORCHARD SHREDDER** **List**

Pull type, 200 hp gearbox, 540 CV-PTO, 3-groove belts, 1/4" hood, 3/8" ends, 2.1# side knives, HD rake, jack stand

4', single end drive, 2 tires	OIS4PT		\$20,886
5', single end drive, 2 tires	OIS5PT		\$21,530
7', single end drive, 4 tires	OIS7PT	4558#	\$23,758
8', dual end drive, 4 tires	OIS8PT	5209#	\$26,292
9', dual end drive, 4 tires	OIS9PT	5860#	\$27,550
Dual drive, for 4', 5' or 7', ADD			\$1,380

**FIELD SHREDDERS, TRAILED** **List**

**End drive**, 200 hp gearbox, 1000 rpm CV-PTO, 1/4" hood, CHOOSE 1.4# side cut or cup knives, ADD tires, ADD lift kit

12', 2-gr belts, 2 wheels	S12PM	3300#	\$18,910
15', 2-gr belts, 4 wheels	S15PM	4100#	\$21,800
18', 3-gr belts, 4 wheels	S18PM	4900#	\$26,140
20', 3-gr belts, 4 wheels	S20PM	5300#	\$27,080
22', 3-gr belts, 4 wheels	S22PM	6900#	\$29,270
24', 3-gr belts, 4 wheels	S24PM		\$36,040
25', 3-gr belts, 4 wheels	S25PM		\$37,810
26.5', 3-gr belts, 4 wheels	S26.5PM		\$38,690

**BT End drive**, 300 hp gearbox, 1000 rpm CV-PTO, 1/4" hood, side knives, CHOOSE 2.05# side cut or cup knives, ADD tires, ADD lift kit

15', 3-gr belts, 4 wheels	SBT15PM		\$23,690
20', 3-gr belts, 4 wheels	SBT20PM		\$29,430
25', 3-gr belts, 4 wheels	SBT25PM		\$41,070

**Center drive**, 200-300hp gearbox, 1000rpm CV-PTO, 1/4" hood, CHOOSE side-cut or cup knives, ADD tires, ADD lift kit

12', 2 wheels, 200 hp gbox	D12PM		\$18,400
15', 4 wheels, 300 hp gbox	D15PM		\$20,400
18', 4 wheels, 300 hp gbox	D18PM		\$25,100
20', 4 wheels, 300 hp gbox	D20PM	5700#	\$26,800
22', 4 wheels, 300 hp gbox	D22PM		\$29,600
24', 4 wheels, 300 hp gbox	D24PM		\$30,740
25', 4 wheels, 300 hp gbox	D25PM		\$31,940
26.5', 4 wheels, 300 hp gbox	D26.5PM		\$33,650
30', 6 wheels, 300 hp gbox	D30PM		\$38,130

**MOUNTED, SEMI-MOUNT, WINDROWER** **List**

<b>Fully Mounted</b> version, DEDUCT		(\$190)
<b>Semi-Mount</b> version, ADD		\$4,880
Windrower version, 12', 2 wheels, ADD		\$4,640
Windrower version, 15', 4 wheels, ADD		\$4,860
Windrower version, 18', 4 wheels, ADD		\$3,630
Windrower version, 20', 4 wheels, ADD		\$4,770
Transport kit, to 26.5', mtd & pull		\$6,680

**COMPLETING CHOICES** **List**

TIRE, 9.5Lx15 implement tire, mounted, EACH		\$190
LIFT, manual ratchet jack, 1 for 12' and 15'		\$180
LIFT, manual ratchet jack, 2 for 18' & up		\$370
LIFT, hydraulic kit, for 12' and 15' shredders		\$480
LIFT, hydraulic kit, for 18' and larger shredders		\$680

**OPTIONS** **List**

Hardened side cut knives, EXCHANGE, PER FOOT		\$70
1 3/4" PTO drive line		N/C
300 HP gearbox, exchange for 200 HP		\$380
Speed-up kit, 147 mph (12,900 fpm) @ 2000 rpm		\$800
Rice Package, 5-gr belt, 300 hp gbox, speed-up		\$3,310
Extra gauge wheel assy, PAIR, ADD tires		\$860
Extra caster wheel assy, PAIR, ADD tires		\$3,870
Center crop divider		\$110
Disc hitch		\$130
Rear LED light kit, 7-PIN connector		\$670

**FREIGHT:** Utah, So. Idaho 6% of list price; Other Areas 9%.  
**FACTORY WARRANTY:** 1 Year on parts (5 yrs on gearbox, 2 yrs on impeller, NO SAND), FOB factory; no labor; w/limitations.  
 All orders are also subject to the dealer Sales & Security Agreement, our latest Discounts and Terms, and credit approval.